



Content

- Package List.....2
- Disclaimer and Warning.....3
- Safety Operation Guidelines.....4
- USB Connection.....5
- Mounting Camera, Checking Balance6
- Panel Introduction.....8
- Operating Mode.....10
- Changing Orientation.....11
- App Operation and Bluetooth Connection12
- Product Specifications & Warranty.....13

Package list

The product should be packed with the following items (including this user manual). If you are missing any items or components, please contact your dealer immediately.

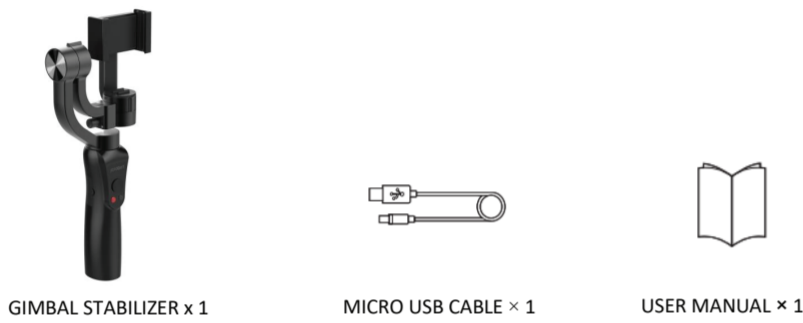

2.

Disclaimer and warning

Thank you for purchasing our stabilizer. Before you start, please read this manual and get accustomed with stabilizer's components and operating modes to ensure proper operation. The information contained herein affects your safety and your legal rights and responsibility. Failure to read and follow the instructions and warnings may result in serious injury to you or damage to your device or property.

By using this product, you declare that you have read this document carefully and that you understand and agree to abide by the terms and conditions herein. You agree that you are solely responsible for your conduct while using this product and for any consequences thereof. You agree to use this product only for purposes that are proper and in accordance with all terms, precautions, practices, policies and guidelines our company has made and may make available.

Our company accepts no liability for damage, injury or any legal responsibility incurred directly or indirectly from the use of this product. The user shall apply safe and lawful practices including, but not limited to those set forth herein.

GLOSSARY

The following terms are used throughout the product literature to indicate various levels of potential harm when operating this product.

WARNING: Procedures which, if not properly followed, may incur property damage, grave accident or serious injury.

CAUTION: Procedures which, if not properly followed, may incur property damage and serious injury.

NOTICE: Procedures which, if not properly followed, may incur property damage or minor injury.

WARNING:

Read the ENTIRE user guide to become familiar with the features of our stabilizer before operating. Failure to operate the product correctly can result in damage to the product or personal property and cause serious injury. This is a sophisticated product. It must be operated with caution and common sense and it requires some basic mechanical ability. Incorrect use of the product in a safe and responsible manner could result in injury or damage to the product or other property. This product is not intended to be used by children without direct adult supervision. DO NOT use the product with incompatible components or in any other ways than those mentioned or instructed in the product documents provided by our company. This Safety Guidelines herein contain instructions for safe operation and maintenance. It is essential to read and follow all the instructions and warnings in the user manual prior to assembly, setup or use, in order to operate the product correctly and avoid damage or serious injury.

3.

Safe operation guideline

The stabilizer should be used in temperatures ranging from 0°C to 40°C. Use of the battery in environments above 40°C can lead to a fire or explosion. Use of battery below 0°C can lead to serious damage.

CHARGING THE BATTERY

1. Always use our company approved charger for charging. Our company takes no responsibility if the battery is charged using other chargers than the ones approved by our company.
2. Do not put the stabilizer near flammable materials or on flammable surfaces (such as carpet or wood). Never leave the battery unattended during charging to prevent any accidents.
3. Do not charge the battery immediately after use, when the stabilizer temperature may be too high. Do not charge the battery until it cools down to ~ room temperature. Charging the battery when its temperature is higher than 40°C or lower than 5°C may lead to leakage, overheating or battery damage.
4. Examine the charger and cable before use; make sure there is no damage to the enclosure, cord, plug or other parts. Never use a damaged charger. Do not clean the charger with denatured alcohol or other flammable solvents.
5. The Intelligent Battery will stop charging when it is full. Disconnect the batteries from the charger when fully charged.

STORAGE

1. DO NOT leave the stabilizer near heat sources such as a furnace or heater or exposed inside a vehicle on hot days.
2. Store the stabilizer in dry environments and never store the stabilizer in any environment with temperatures higher than 60°C.
3. Do not leave the stabilizer unused for too long after it has been completely discharged to prevent over-discharge of the battery, which may result in permanent battery damage.

TRAVEL NOTICE

Discharge the battery to 5% or lower before carrying it on an air flight.

CAUTION:

1. The stabilizer is a high-precision control device. The stabilizer can be damaged if it is dropped or subjected to external force, actions that can result in malfunction.
2. Make sure the rotation of the stabilizer's axes is not blocked by external forces when the stabilizer is powered on.
3. The stabilizer is not waterproof or water-resistant. Avoid contact with any kind of liquid. For cleaning, it is recommended to use a dry cloth.
4. Protect the stabilizer from dust and sand during use.

4.

Safe operation guideline

NOTE

1. Hold the stabilizer's handle still when it is powering up, to ensure it powers-on correctly.
2. Make sure the batteries are fully charged before each use.
3. Discharge the battery to 40% - 65% if the stabilizer will NOT be used for the next 10 days or more. This can greatly extend the battery life.
4. Charge and discharge the battery completely once every 3 months to keep it active.

USB connection

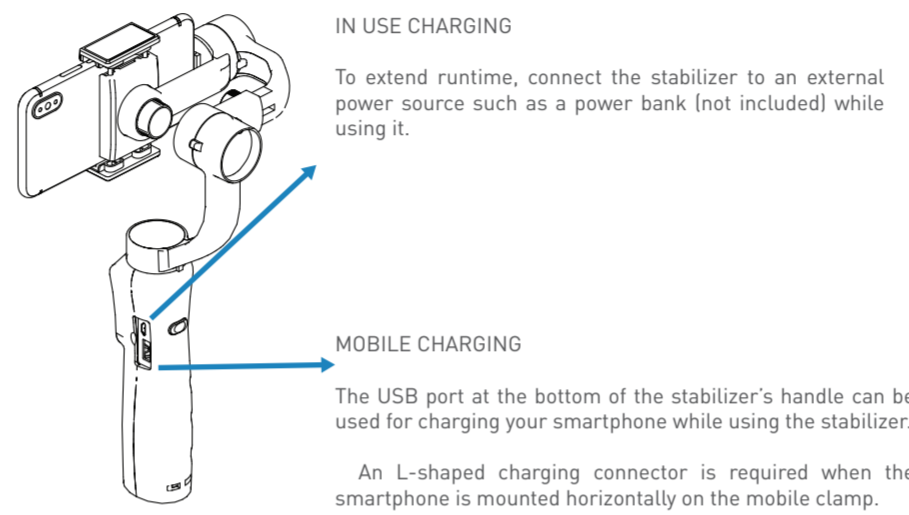

5.

Mounting camera

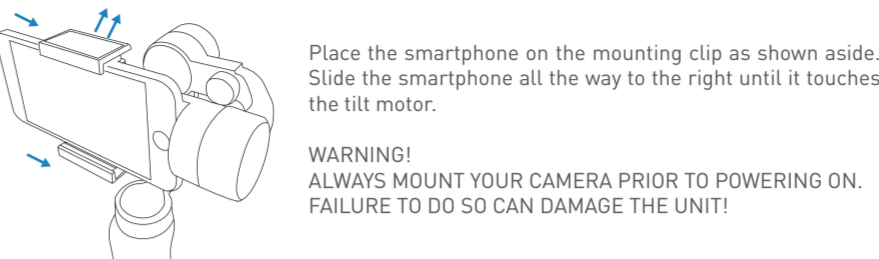

Checking balance

If the smartphone does not stay leveled when mounted, please do as following:
Step 1: Loosen the roll balance knob.
Step 2: Make small adjustments by sliding the horizontal arm, until the smartphone intersects the stabilizer with a 70-100 degrees angle.
Step 3: Tighten the thumb screw after the phone is well balanced in level to ensure normal operation.

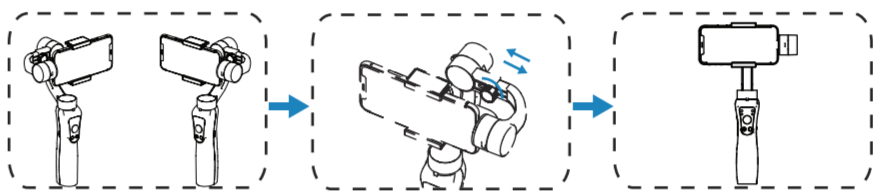

NOTE:
Proper adjustment of balance ensures better power saving during operation. The stabilizer may still function well even when the gravity center is not properly configured; however, it may lead to more power consumption on the motors and can greatly affect the torque output.

6.

Operating

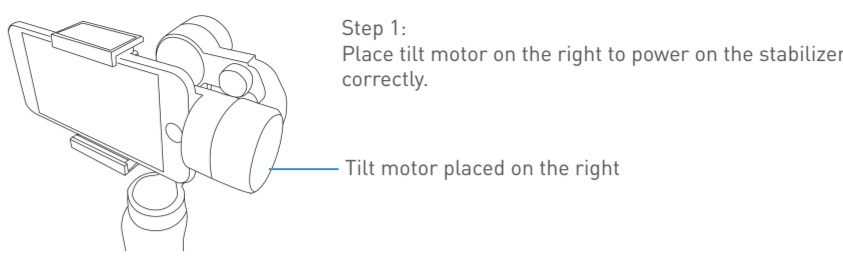

WARNING:
The stabilizer can't be powered on if the tilt motor is placed on the left.

Step 2:
To Power On, hold the power button for a few seconds until the Status indicator light flashes blue and turns green.

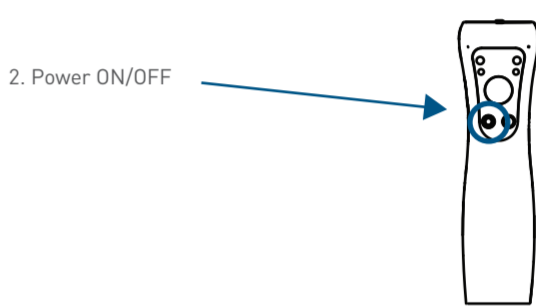

7.

Panel introduction

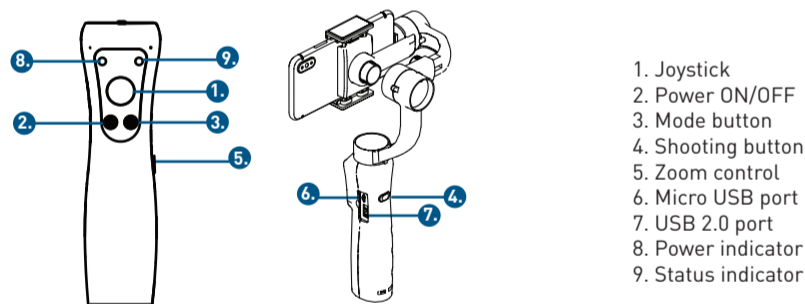

1. Joystick
2. Power ON/OFF
3. Mode button
4. Shooting button
5. Zoom control
6. Micro USB port
7. USB 2.0 port
8. Power indicator
9. Status indicator

1. JOYSTICK

Control movement UP/DOWN [Tilt Motor] and LEFT/RIGHT [Pan Motor].
*The Joystick can be used in all 3 modes.

2. POWER ON/OFF

To Power On, hold the power button for a few seconds until the Status indicator light flashes blue and turns green. To Power Off, repeat the instructions above.

In App only

Video / Photo Mode: tap the power button 3 times to switch between Video/Photo mode. Front / Rear camera: tap the power button 2 times to switch between Front/Rear camera.

3. MODE BUTTON

Single press to cycle through the 3 modes. Double Click the Mode Button to bring the camera to its original position.

4. SHOOTING

After establishing a Bluetooth connection between the mobile and the stabilizer, use SHOOT button to take photos/videos.

5. ZOOM CONTROL [in APP only]

Use the zoom slider to control UP [Zoom In] and Down [Zoom Out].

6. USB 2.0 PORT

The USB 2.0 port can be used to charge your smartphone while using the stabilizer.

8.

- a. Connect the micro USB port to a portable power source such as an USB power bank to extend runtime.
- b. Use a cable to charge the stabilizer when it has no power.

8. POWER INDICATOR LIGHT

Blue Light is always on - enough remaining battery power.
Power light flashes rapidly - low battery power.

9. STATUS INDICATOR LIGHT

- Blue Light - The stabilizer is in operation, the control unit goes through processing an instruction.
- Green Light - stabilizer has gone into working condition.
- Red Light - Red Light is always on - low on charge -> shut down.
- Red Light is blinking rapidly - stabilizer overloaded -> shut down.

Operating modes

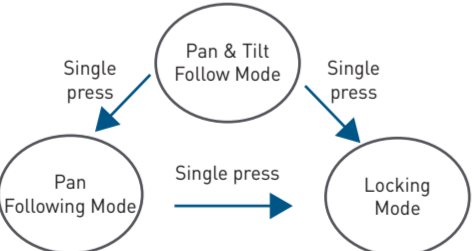

Please consider every motor and operating mode details (shown on this page), as the stabilizer comes pre-programmed with 3 different modes.

SWITCHING BETWEEN STABILIZER'S MODES

Press the Power Button -> The stabilizer enters Pan & Tilt Follow Mode automatically when powered on (Default Mode).
Single Click Mode button -> switch into Pan Following Mode.
Single Click the Mode button -> switch to Locking Mode.

9.

Operating modes

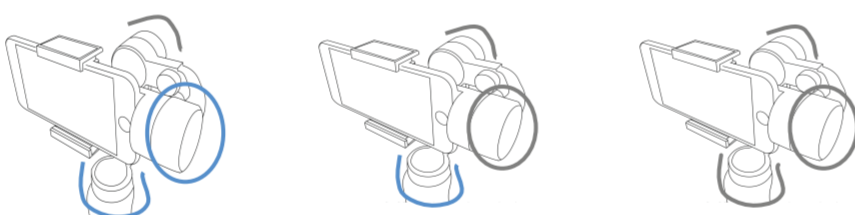

Roll axis is locked. The camera pans (left/right) and tilts (up/down) are following the hand's movement.

Push joystick up and down to control the tilt of camera. Use joystick left and right to manually pan left/right.

Tilt & Roll are locked. Pan axis rotates (left/right) smoothly, following the turn of the wrist.

Push joystick up and down to control the tilt of camera. Use joystick left and right to manually pan left/right.

Pan, Tilt and Roll axis are all locked. The camera stays still and stable, which means the camera can't follow the handle's movement.

Push joystick up and down to control the tilt of camera. Use joystick left and right to manually pan left/right.

10.

Change orientation

The stabilizer comes with 2 different ways of changing the orientation

- Switching from horizontal to vertical

Keep the phone facing yourself and rotate the stabilizer's handle over 70 degrees in counterclockwise direction -> stabilizer will enter vertical shooting mode (phone camera downward).

Keep the phone facing yourself and rotate the stabilizer's handle over 70 degrees in clockwise direction -> stabilizer enters vertical shooting (phone camera upward).

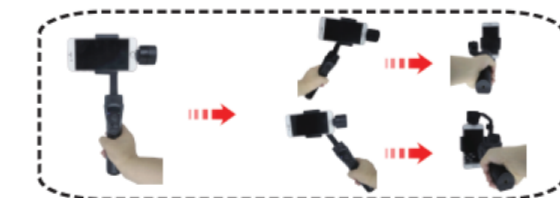

Switching Mount Direction

- Step 1: Loosen the smartphone clamp thumbscrew and rotate the clamp to vertical direction;
- Step 2: Place your smartphone on the clamp;
- Step 3: Tighten the clamp thumbscrew to ensure normal operations.

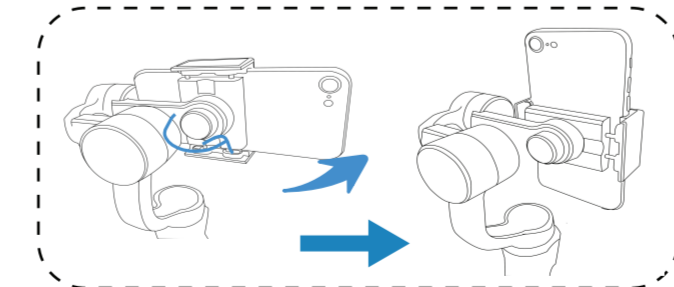

11.

App operation & Bluetooth connection

Connect to Stabilizer app

Step 1: Scan QR code (for Android + iOS) and download the app for accessing;

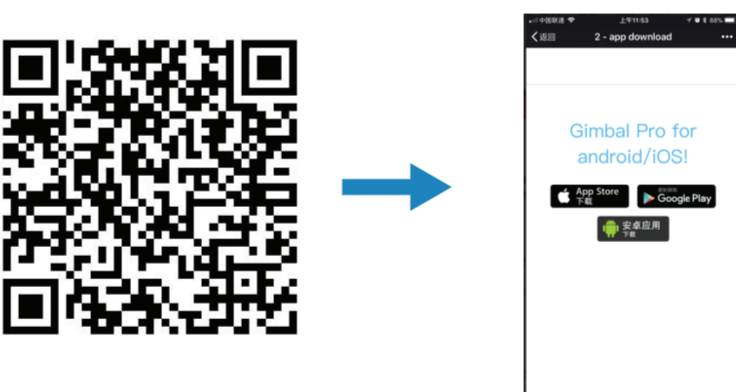

- Step 2: Power on the stabilizer;
 - Step 3: Activate Bluetooth from your smartphone's settings menu;
 - Step 4: Open the stabilizer app and search for the stabilizer Bluetooth signal by selecting the Bluetooth icon in the pop-up screen.
- In the app menu, use the zoom slider to control UP [Zoom In] and Down [Zoom Out] and more functions such as Face Tracking, Smart Object Track, Panorama Shooting, Time-Lapse.

Connect to Bluetooth

- Step 1: Press the Power button for 3-4 seconds -> stabilizer will power on.
- Step 2: Activate Bluetooth from your smartphone's settings menu.
- Step 3: After establishing a Bluetooth connection between the mobile and the stabilizer you can start taking photos/videos.

12.

Product specifications & Warranty

Stabilization System: 3-Axis
Compatibility: Smartphone max size 6" and action cameras
Maximum payload: 200g
Tilting Angle: 325°
Rolling Angle: 180°
Panning Angle: 320°
App: Yes (Gimbal Pro)
Bluetooth: Yes
Vertical Shooting: Yes
Operating Modes: Pan & Tilt mode (Default mode), Pan Following mode, Lock mode
USB output: 1A
Firmware Upgrade: Through APP, with upgrade failure protection
Operating Time: up to 12 hours
Charging Time: 4-5 hours
Battery: 4400mAh
Dimensions: 290*120*47mm
Weight: 460g
Operating Temperature: 0°C-40°C
Standard Accessories: Action camera adaptor + USB cable + Manual

Warranty does not cover:

1. Products subjected to unauthorized maintenance, misuse, collision, neglect, mishandling, soaking, accident and unauthorized alteration.
 2. Incorrect use of product: removing serial number labels/tags.
 3. Products whose warranty has expired.
 4. Products damaged due to force majeure, such as fire, flood, lighting etc.
- Warranty Claim Procedure
If failure or any problem occurs to your product after purchase, please contact a local agent for assistance.
Latest Information
For the latest user manuals, tutorial video, firmware and calibration instruction, please visit www.tellur.com.

13.